

INSTRUCTION MANUAL

Wheel Chair KK-T500H/T501H Series



Preface

Thank you for your purchase of the wheel chair.

This instruction manual describes precautions and how to safely use and operate the wheel chair.

- To ensure safe and proper use of the wheel chair, be sure to read this instruction manual before using it.
- The safe and correct operating procedures should be explained not only to the person using the wheel chair but also to the patient's family.
- After reading this instruction manual, store it in a place that can be easily accessed for later reference.
- Some of the descriptions in this manual may differ from the product you have purchased due to model refinements.
- For any queries, please feel free to contact your dealer or Paramount Bed.

Dimension

(mm)

Model	Caster (Inch)	Wheel (Inch)	Front seat	Back seat	Seat length	Arm support height	Back support height	Foot length	Overall length	Overall height	Overall width	Folded width	Weight (kg)
KK-T500H/T501H	7	24	470	440/420	400	235	380	350~	1050/1035	880/865	620	330	17.6/19.6/-

*KK-T500H: Air tire type / KK-T501H: No-puncture tire type

Functions

Model	Type	Back support	Arm support	Foot/leg support	Brake
			Function	Function	Parking
KK T500H/T501H	Standard	Fixed	—	—	○

Parts name

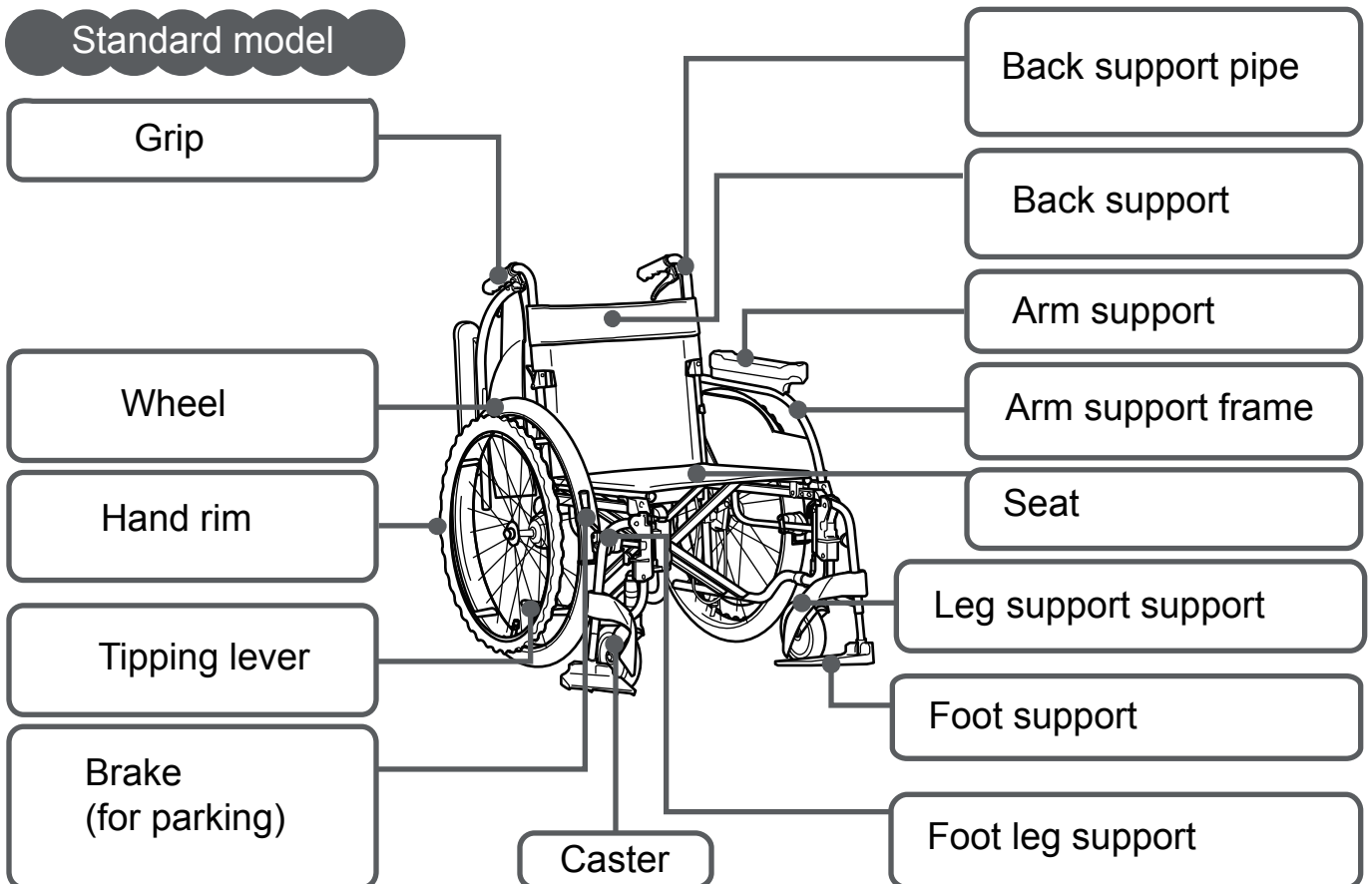

To get on /off the wheel chair



Warning

- Be sure to brake the wheels when getting on/off the wheel chair or transferring to bed. (There is a risk that the wheel chair may move and user fall off, resulting in injury)



Warning

- Avoid getting on/off the wheel chair over uneven floor. (There is a risk that the wheel chair may lose balance and user fall off, resulting in injury)

To get on

- 1 Brake the both wheels

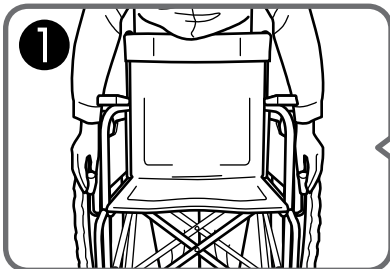

- 2 Raise up the both foot supports

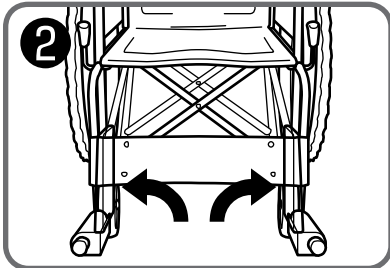

- 3 Sit on the seat slowly while holding the arm supports

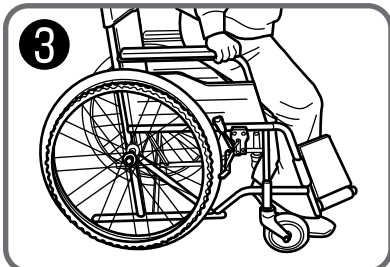

- 4 Put the feet on the foot supports

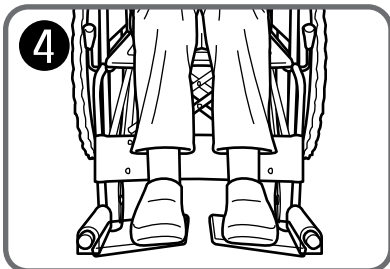

Brake lever

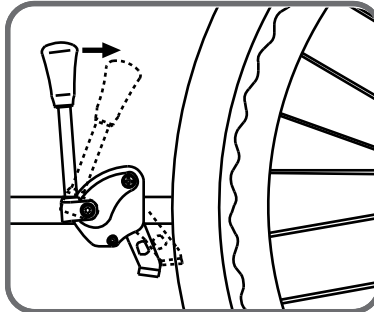

To get off

- 1 Brake the both wheels

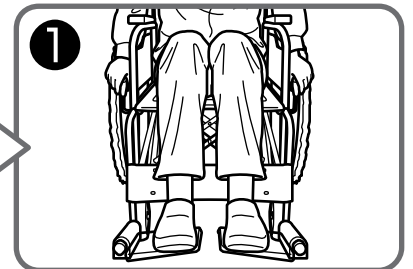

- 2 Raise up the foot supports and lower the legs

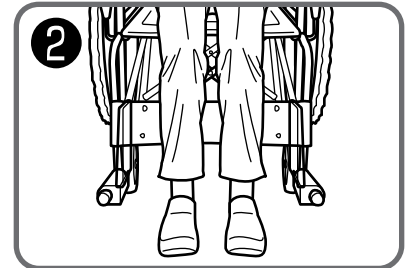

- 3 Stand up slowly while holding the arm supports

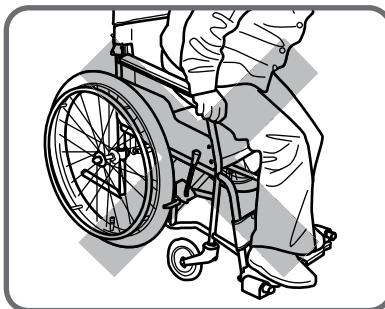
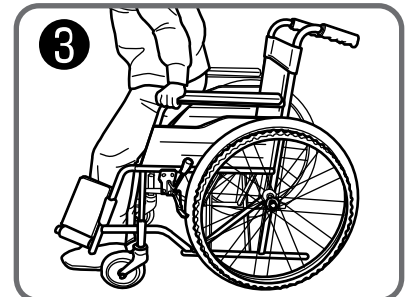

Warning

- Do not step on the foot supports when getting on/off the wheel chair. (There is a risk that the wheel chair may lose balance and user fall off, resulting in injury)

Using brake lever

- To lock the brake, pull the lever backward
- To unlock the brake, push the lever forward

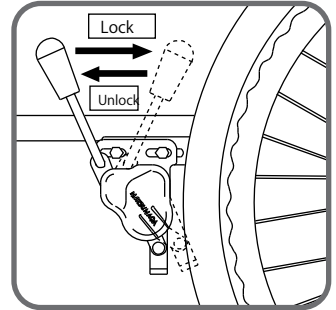
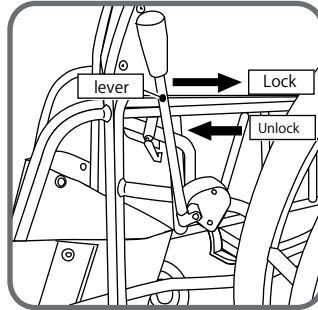
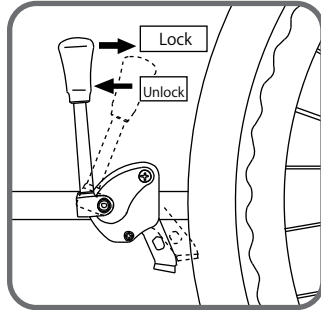
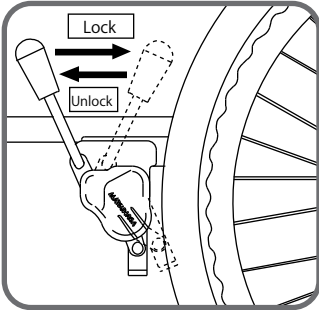

Warning

- Do not lock the brake if the air pressure of tire is low. (There is a risk that the wheel chair may move because it is not properly braked, resulting in an accident.)



Warning

- Be sure to lock the brake when getting on/off the wheel chair or transferring to bed. (There is a risk that the wheel chair may move and user fall, resulting in injury.)

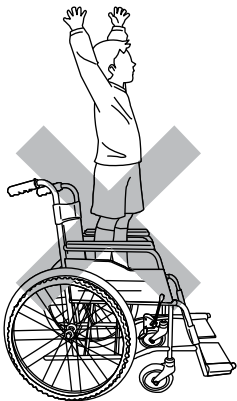

Warning

- Do not stand on the seat. (There is a risk of falling.)

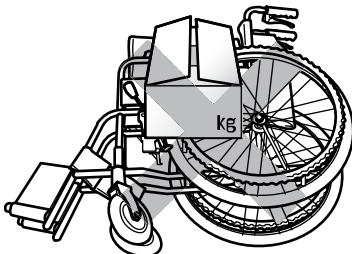

Caution

- Do not put anything on the wheel chair laid sideways. (Wheels frame may bend, resulting in malfunction.)

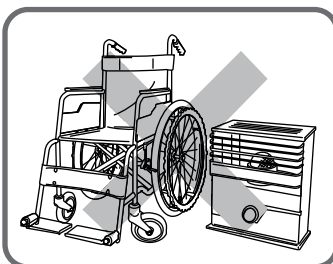

Caution

- Keep the wheel chair away from fire. (They could cause puncture to tires or set fire on seat.)



Caution

- Do not transport the wheel chair carrying goods.